

**FOR
LEASE**

720 N. Old Woodward, Birmingham, MI

Offices from 1,000 – 2,500 SF Undergoing Complete Remodeling



Property Highlights

- Office zoning
- Undergoing complete remodeling
- Available surface & city parking
- Great downtown location in Birmingham
- Short walking distance to restaurants and shopping
- Balcony view of beautiful Creekside



**FOR
LEASE**

720 N. Old Woodward, Birmingham, MI

Offices from 1,000 - 2,500 SF Undergoing Complete Remodeling

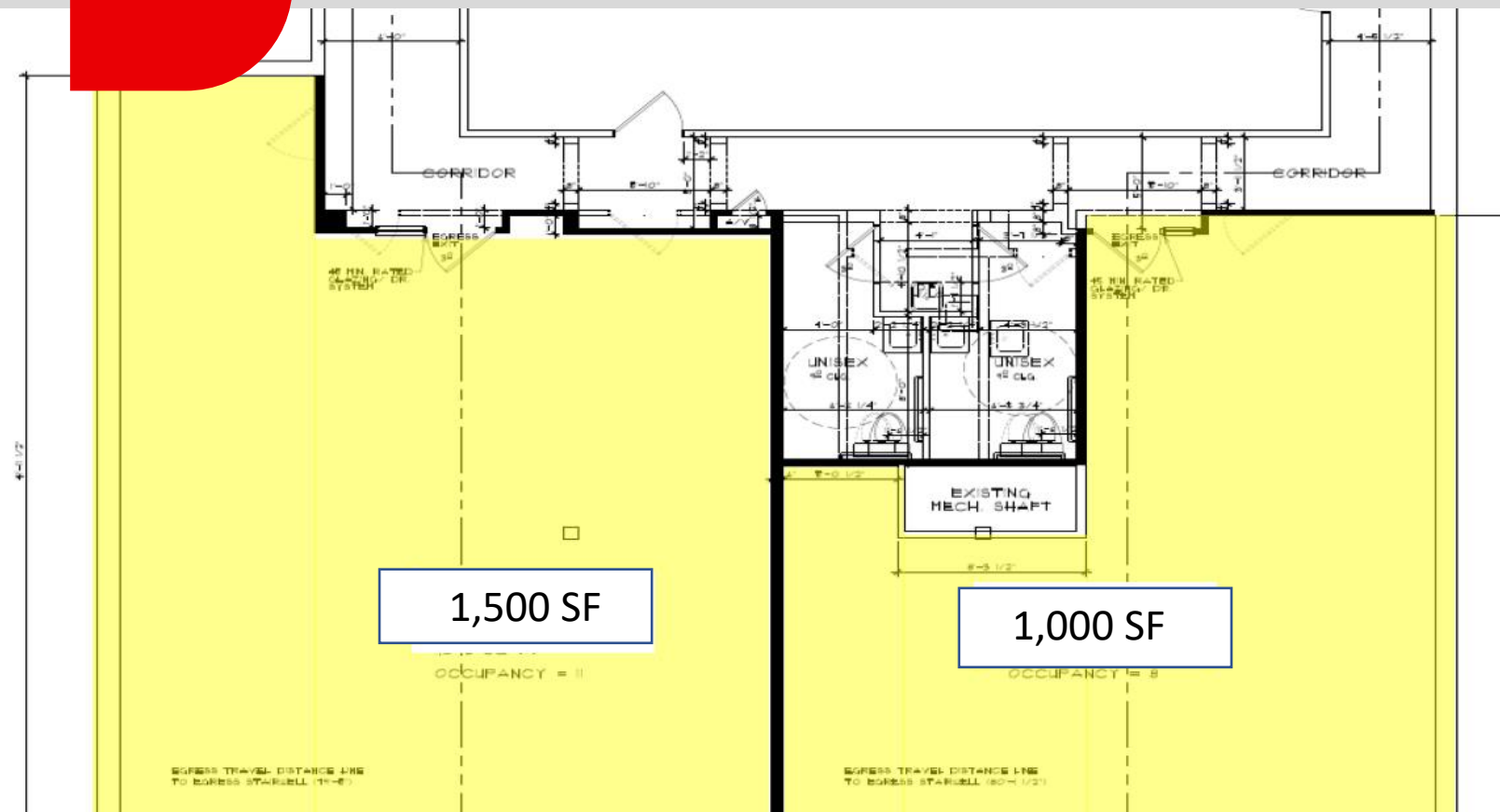

Building Address: 720-726 N. Old Woodward

Date Available: Immediate

Zoning: O-2, Office Commercial

Building Type: Three Story, Brick Façade

Square Footage: 15,000 Total Building Sq. Ft.
1,000 – 2,500 Sq Ft Suites Available

Parking: Abundant Surface & City Parking

Additional Info: Close proximity to Woodward, Maple
and Public Transportation

One block north of Maple

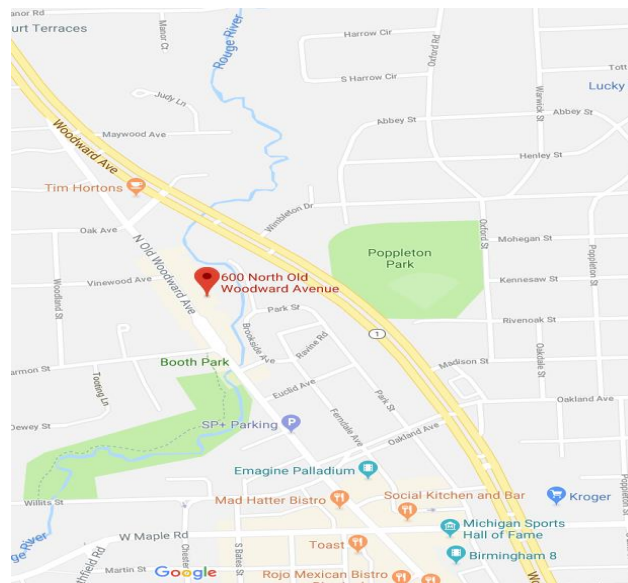

For more information please email info@najorcompanies.com